

greenteQ Climate Conformal System

EDITION I / 2013



greenteQ Climate Conformal System

0.04 W/mK thermal conductivity	up to 1,050 Pa driving rain resistance	< 0.1 airtightness	up to 3,000 Pa pressure and suction
Class 4 pendulum impact test	up to 150 kg load transfer	B1 fire class	

The tightening in recent years of the German Energy Saving Ordinance (EnEV) regulations has clearly been necessary in order to further optimise energy efficiency in buildings.

It cannot be denied, however, that this has presented planners, architects and tradespeople with major challenges. Installation experts are thus currently being asked to offer innovative solutions with correspondingly optimised installation details that not only comply with the German Energy Saving Ordinance (EnEV) regulations but also win over customers in terms of their practicality.

The greenteQ Climate Conformal System offers you, as an installation expert, three interesting options in the area of curtain wall installation (standard, external and concealed subframe installation); these are not only versatile enough to allow customised solutions, they can also be quickly and simply installed:



- greenteQ Climate Conformal Profile
- + greenteQ MS Polymer Adhesive white
- + greenteQ Window Frame Screw FH
- + greenteQ Window Frame Screw CH
- =====
- = greenteQ Climate Conformal System

www.greenteQ.info

The greenteQ Climate Conformal System consists of just four components, can be used universally and has been awarded the system audit certificate of ift Rosenheim.



SYSTEM-TESTED

greenteQ CLIMATE CONFORMAL SYSTEM

Sealing variant A

Side section

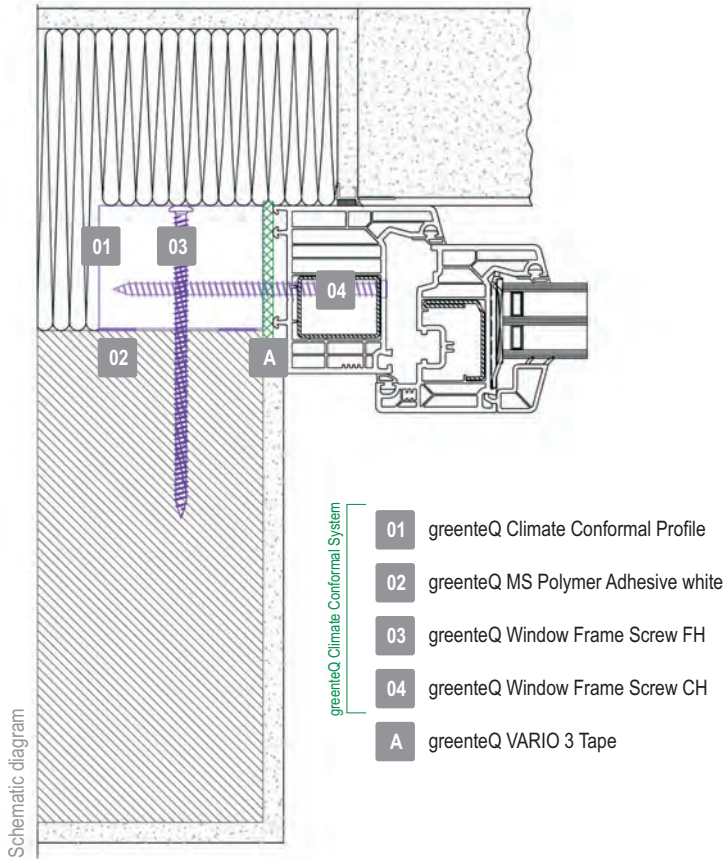

Window units can be directly integrated into the insulating layer thanks to the greenteQ Climate Conformal System. Thermal bridge-free wall connections are thus possible.

System characteristics of the greenteQ Climate Conformal System:

- Simple assembly process
- Profiles can be easily processed
- Just a few components
- Three options with different sealing variants (A, B, C, D)
- Installation acc. to choice or requirement of planner/installer (standard, external and concealed subframe)
- Lightweight materials
- Preassembly possible as frame
- Quicker window installation
- Subsequent window replacement possible without plasterwork (concealed subframe installation)



Preassembly of frame in case of external installation

Lower section

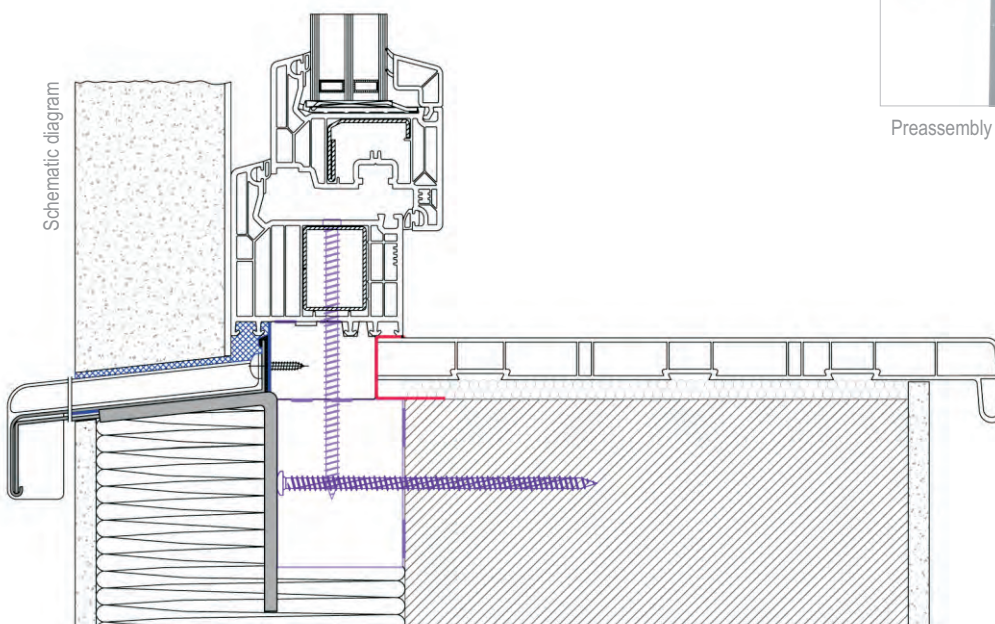

Why use the greenteQ Climate Conformal System?

Up to now, the window has been the weak point in modern ETICS façades both in relation to the isothermal profile and in the area of thermal bridges. This is precisely where the greenteQ Climate Conformal System comes in. Due to the use of state-of-the-art construction insulating and sealing materials, the greenteQ Climate Conformal System is able to optimise this weak point at the window frame profile (U value, heat transfer coefficient etc.). As a result of the maximum insulation properties, it thus prevents potential thermal bridges and allows variable positioning of the window towards the inside/outside in the window reveal.

This results in welcome savings on heating costs for the consumer and besides being kind to your wallet is also environmentally friendly.

3-10 L
Heating oil savings
per window unit
and year

The greenteQ Climate Conformal System offers three optimal problem-solving approaches depending on the façade requirement:

- Standard Climate Conformal installation
- External Climate Conformal installation
- Concealed subframe Climate Conformal installation

The sealing and joint insulation can be realized in the usual manner in different ways depending on the requirements.

The test reports from ift Rosenheim also verify the high system reliability of all shown variants.

The greenteQ Climate Conformal System, which has just four components, is characterised by its simple processability, ease of installation as well as long service life.

A subsequent window replacement can, depending on the selected variant, also be realized with little and/or indeed no chiselling and plasterwork on the façade.

The greenteQ Concealed Subframe Climate Conformal System allows installation at the end of the construction phase and thus also allows windows to be replaced without any plasterwork even after decades.

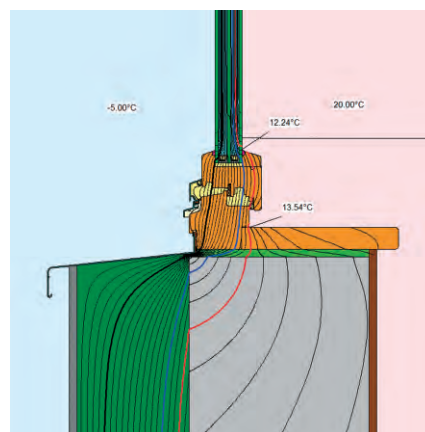

Previous standard window installation

ψ -value: 0.091 W/mK

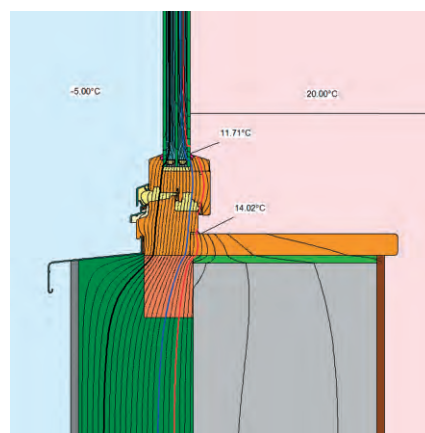

greenteQ Climate Conformal System window installation in insulating layer

ψ -value: -0.0033 W/mK





Measuring and cutting the greenteQ Climate Conformal Profiles to size
Mark the respective dimension on the greenteQ Climate Conformal Profile and cut to size



greenteQ MS Polymer Adhesive White application
Apply the greenteQ MS Polymer White Adhesive in two even adhesive beads



Lower greenteQ Climate Conformal Profile
Attach greenteQ Climate Conformal Profile on wall and secure using greenteQ Window Frame Screws Flat Head

INSTALLATION STEPS - greenteQ CLIMATE CONFORMAL SYSTEM

(General statements, please see the installation instructions for detailed information.)



Side greenteQ Climate Conformal Profiles
Align greenteQ Climate Conformal Profiles with the perpendicular and secure using greenteQ Window Frame Screws Flat Head



Upper greenteQ Climate Conformal Profile
Attach greenteQ Climate Conformal Profile at top on side Climate Conformal Profiles and secure using greenteQ Window Frame Screws Flat Head



Windows in greenteQ Climate Conformal System
Perfectly integrated into the ETICS façade - thanks to the greenteQ Climate Conformal System

0.04 w/mk thermal conductivity	Class 4 pendulum impact test	up to 1,050 Pa driving rain resistance	< 0.1 airtightness	up to 3,000 Pa pressure and suction
			up to 150 kg load transfer	B1 fire class



The expert brand for window and door hardware

- More selection
- More service
- More brands
- More quality



- More advice
- More local
- More experience
- More reliability